



भारतीय विज्ञान शिक्षा एवं अनुसंधान संस्थान, पुणे  
**INDIAN INSTITUTE OF SCIENCE EDUCATION AND RESEARCH (IISER), PUNE**  
 Main Building, IISER Pune Campus Dr. Homi Bhabha Road, Pune : 411 008

**NAME OF WORK : CONSTRUCTION OF DAYCARE BUILDING AT IISER PUNE.**  
**NIT NO : 152/IISER/PUNE/2019-20**

Date of Issue : 26.08.2020

**CLARIFICATION TO BIDDERS QUERIES**

Clarification of bidders queries for " NAME OF WORK : CONSTRUCTION OF DAYCARE BUILDING AT IISER PUNE. NIT NO : 152/IISER/PUNE/2019-20 " as appended. Queries received on email ID specified in tender document upto 26th August 2020 upto 15.00 Hours were enlisted.

Sr No	Points	Tender reference	IISER Pune Clarification
1	There is no item for excavation up to 30 cm depth	BOQ	This item is not necessary with the scope of work since required depth of excavations at site are more than 30 cm. Measurements will be done as per Level book.
2	Item no.3.08 of BOQ- sliding track of capacity 300 kg is not available in the market, please give the revised capacity.	BOQ Item No-3.08	As specified in BOQ description , load carrying capacity of pair of sliding track is required to be 300Kg , approved make Hafle/Hettich/Godrej. Pl quote accordingly.
3	please give all the drawings of the doors as mentioned in item no.3.12 to 3.21 as well as all the other related drawings of the work.	BOQ Item No-3.21	Enclosed as Annex-A
4	Item no.4.12 of the BOQ-given makes for aluminum fittings are not available in the market, please give the revised make.	BOQ Item No-4.12	Sliding door lock - Make- Star Lock , Nylon wheels - Made in India Bidders to note makes and quote accordingly.
5	Item no.6.03 / 6.04 Request to give the fixed size of the required tile as the rate varies with the sizes or give basic rate for the tiles.	BOQ Item No- 6.03/6.04	Selection range is already defined in the BOQ description. Bidder to quote accordingly.
6	item no.14.11-please give item code for wall mixer as the same is not mentioned in the BOQ.	BOQ Item No- 14.11	Item description modified to " Supplying, installing, testing, commissioning 3 in 1 CP wall mixer provision for over head shower and hand shower with 115mm long bend pipe, connecting leg, spout, CP wall flange, wall mounded shower arm with wall flange and Over head shower etc complete, the works including necessary piping, cutting and making good the walls /floor wherever required, including cost and conveyance of all materials to the site, all labour charges, all taxes etc., complete finished item of work and as directed by the Site Engineer/ In-Charge. The quoted rate shall include cost of all the items given per no of fixture. Jaquar - Three in One wall mixer- model no:- FUS CHR 29281 , Jaquar - Shower arm with wall flange model no: HSH-CHR-1937 , Jaquar - Over head shower- model no: OHS CHR 1989 with flexible tube SHA-CHR-549D8 and Towel Ring AKP-CHR-35721P"
7	Item no.20.02- please revise the Unit of the item waiting for your favorable reply.	BOQ Item No- 20.02	Unit of Measurement of Item No 20.02 stands modified to 'meter'. Bidders to note the revision and quote accordingly.

The original tender document and conditions already issued to the agency along with tender stands modified to the extent of modifications defined in above clarifications and shall form a part of tender document. The bidders are requested to submit clarifications and all its enclosures in original along with the tender document on due date of submission of tender. The bidders are further requested to take note of above modifications and quote their rates accordingly. Soft copies of clarifications and its enclosure shall be made available on Institute website and e-procurement portal for bidders reference.

Registrar and Engineer In-charge  
IISER Pune

End of Document

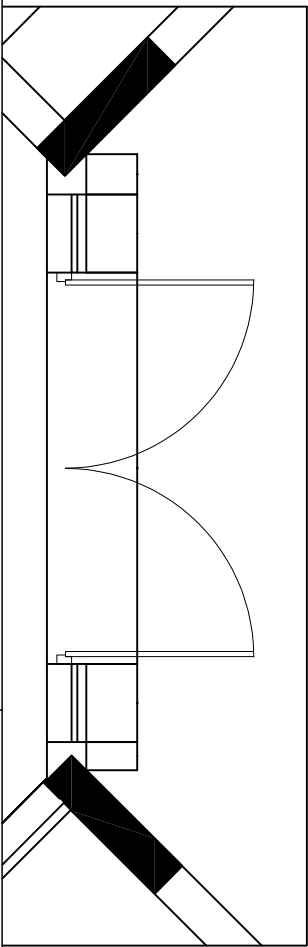
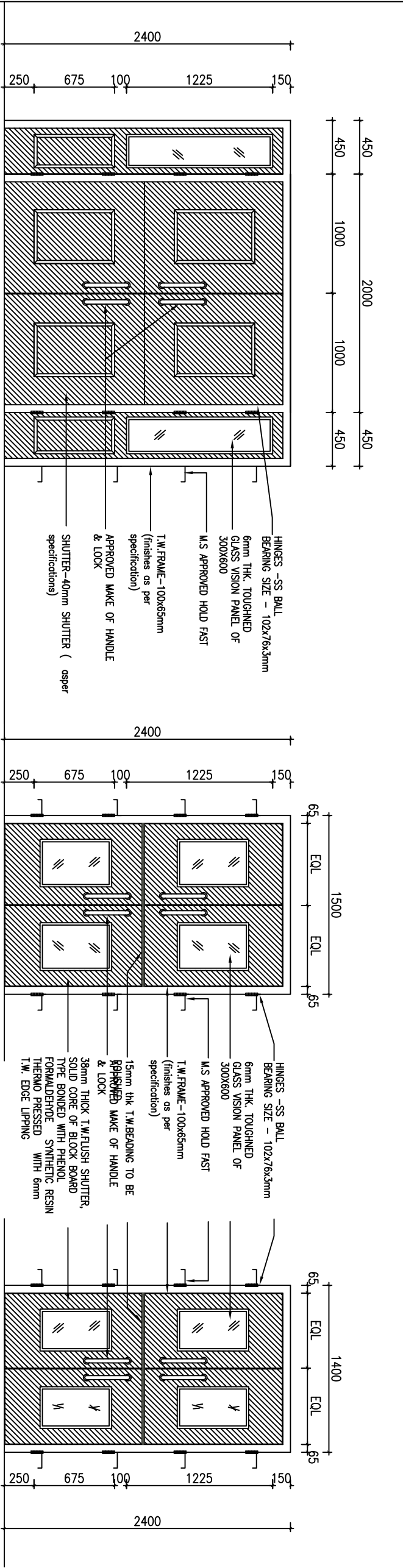

MD -1800x2400  
NELLED DOOR - (EQUAL SHUTTER WITH FIXED PANLES)  
@MAIN ENTRY

D1-1500x2400  
FLUSH DOOR - (EQUAL SHUTTER)  
ACTIVITY ENTRY

D2-1400x2400  
FLUSH DOOR - (EQUAL SHUTTER)  
DINING ENTRY

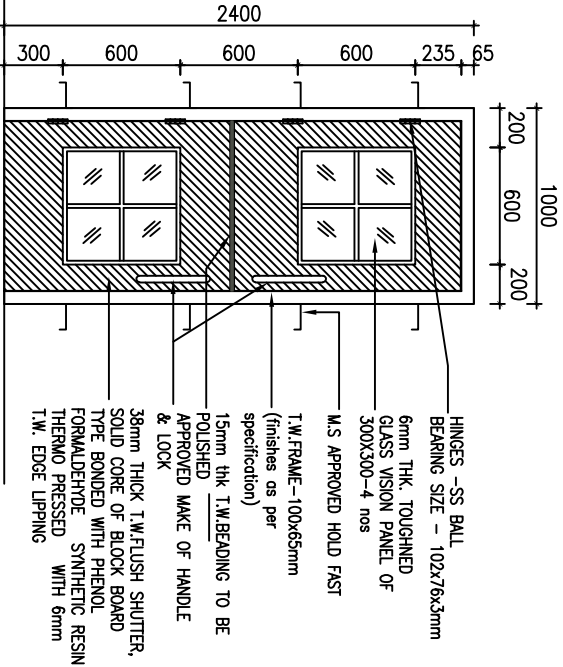

D3-1000x2400  
FLUSH DOOR - TYPE-I

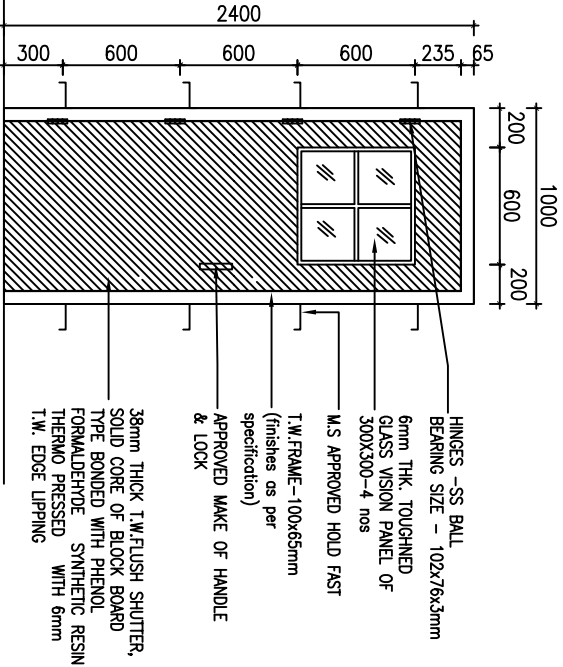

D4-1000x2400  
FLUSH DOOR - TYPE-II

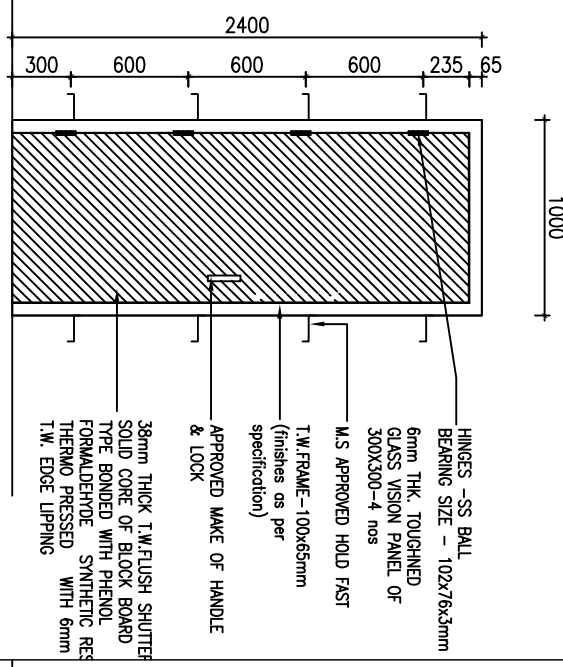

D5-750x2400  
FLUSH DOOR - TYPE-III

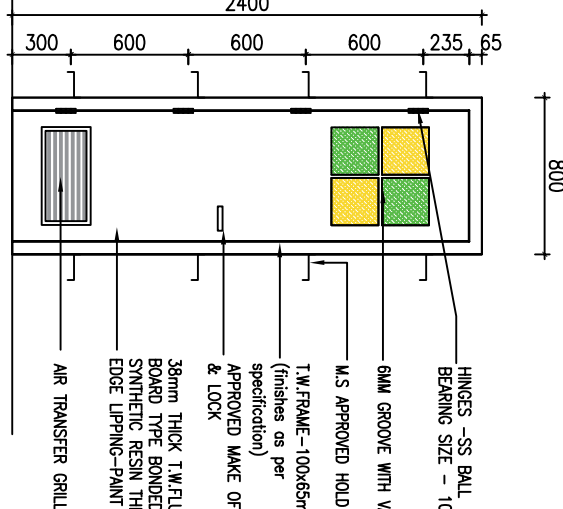

D6-800x2400  
FLUSH DOOR - (TOILET)

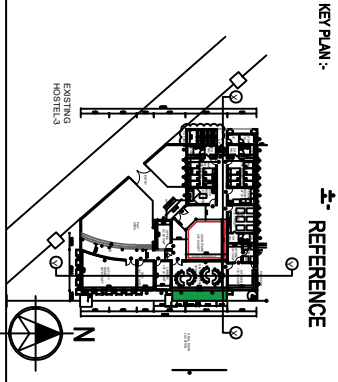

GENERAL NOTES :

SCHEDULE OF JOINERY			
TYPE	DESCRIPTION	SIZE	QTY
D1	MAIN DOOR WITH GLASS PANEL - (Glass and)	1800 x 2400	1
D2	FLUSH DOOR - (Glass and)	1400 x 2400	1
D3	FLUSH DOOR - (Glass and)	1000 x 2400	5
D4	FLUSH DOOR - (Glass and)	1000 x 2400	1
D5	FLUSH DOOR - (Glass and)	750 x 2400	4
D6	FLUSH DOOR - (Glass and)	800 x 2400	5

T1	ISSUED FOR TENDER	04.07.2020	VM	MM
REV.	DESCRIPTION	DATE	BY	CHD.

AMENDMENT			
REV.	DESCRIPTION	DATE	BY

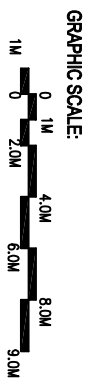

CLIENT:  
INDIAN INSTITUTE OF SCIENCE  
EDUCATION AND RESEARCH(IISER),  
PUNE.

PROJECT:  
PROPOSED CAMPUS FOR IISER PUNE

DRAWING TITLE:  
DAY CARE BUILDING

JOINERY DETAILS - DOOR - TENDER DRAWING

SCALE : 1:100  
DATE : 23.03.2020  
CLIENT SIGNATURE :

DRAWING NO:  
IISER-CDC-AR11-GR-02-270815

design | interiors | engineering | construction management  
C.R.Narayana Rao (Consultants) Private Limited

No. 10, Karagamal Nagar,  
Mysore, Chennai-600 004,  
India  
www.crn.co.in

CRN  
C R NARAYANA RAO